



The product described in the instructions was developed, produced and checked considering the necessary safety requirements. In order to ensure a proper and safe function and to rule out danger for persons and objects, this product must be installed appropriately. Only trained, qualified staff, having the necessary technical experience and tools, should make the installation. Therefore you have to read and completely understand these instructions. Before you start please check the content of the supplied parts as detailed below.



MQS - connector for height level - sensors, to be connected to 4 - pole plug (yellow plug housing supplied).

Power supply/ ground, lines to be connected to standard suspension control unit - plug.
Pin 47 constant power supply (red/ yellow)
Pin 21 ground (brown)

Signal lines of height level - sensors, to be connected to standard suspension control unit - plug.
Yellow/ white Pin 44
green/ red Pin 36
grey/ green Pin 27
black/ white Pin 25

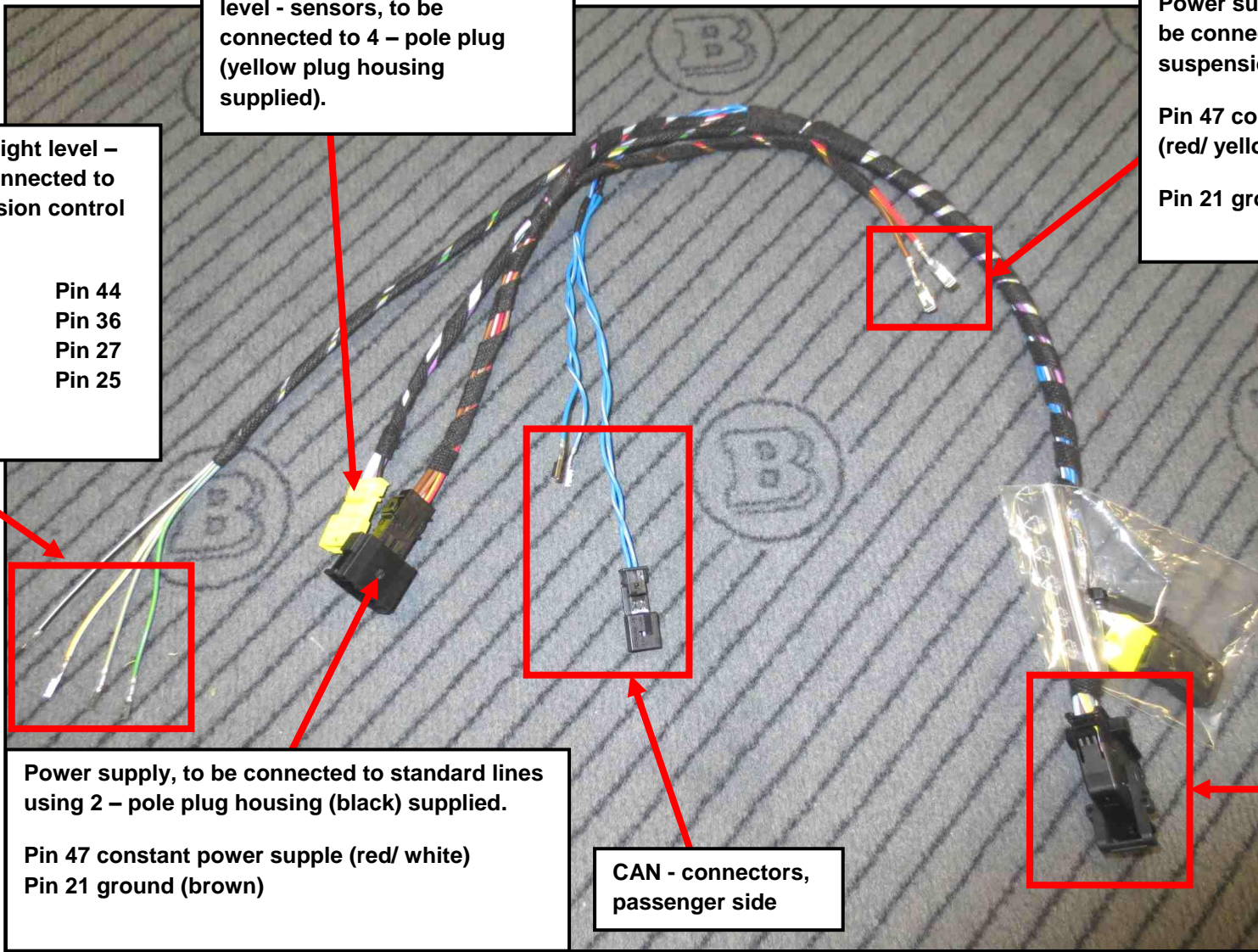

Power supply, to be connected to standard lines using 2 - pole plug housing (black) supplied.
Pin 47 constant power supply (red/ white)
Pin 21 ground (brown)

CAN - connectors, passenger side

Main control unit plug



Installation:

- Adjust passenger seat into rearmost position.
- Disconnect ground line of car main battery prior to installation.
- Fold up the carpet inside the passenger footwell, loosen plastic footrest.

Remove the following signal lines out of the standard suspension control unit – plug using a suitable unlocking tool:

Control unit	Pin 25 (purple)	rear right
Control unit	Pin 27 (grey/ white)	front right
Control unit	Pin 44 (white/ yellow)	front left
Control unit	Pin 36 (white/ black)	rear left

Attach signal lines of height level – sensors to the yellow 4 – pole plug as follows:

MQS Pin 1	(white/ yellow)	front left
MQS Pin 2	(grey/ white)	front right
MQS Pin 3	(purple)	rear right
MQS Pin 4	(white/ black)	rear left

Connect yellow plug to Brabus – wiring harness.

Connect of Brabus wiring – harness to the standard suspension control unit – plug as follows:

yellow/ white	to	Pin 44
green/ red	to	Pin 36
grey/ green	to	Pin 27
black/ white	to	Pin 25

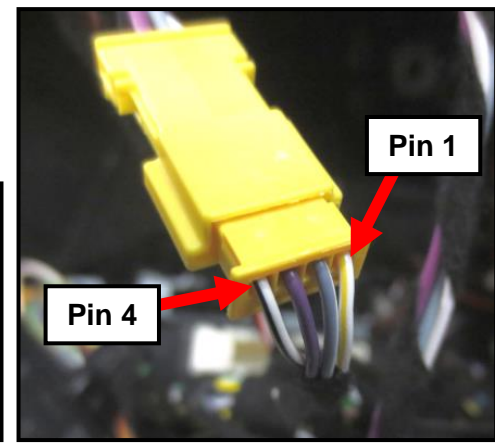
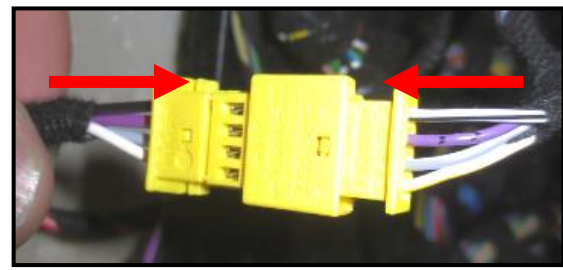
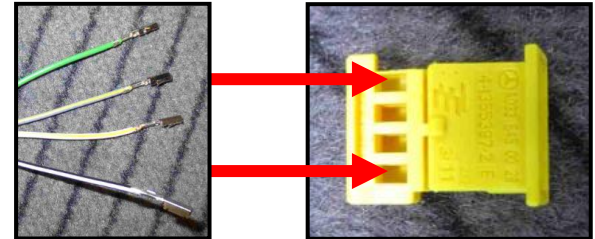
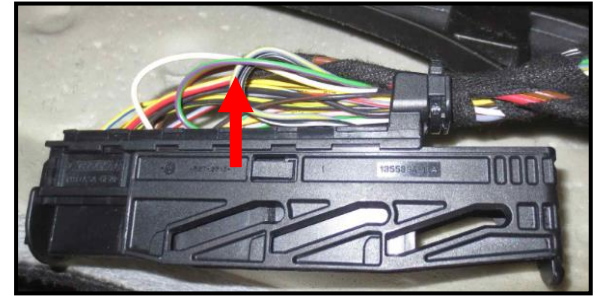
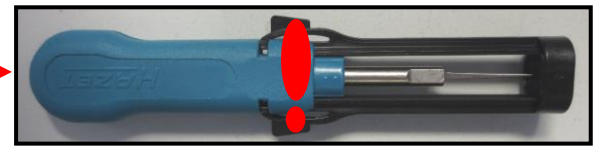



Remove the signal lines for power supply and ground out of the standard suspension control unit – plug using a suitable unlocking tool:

Pin 47 (red/ white 1,5mm²)
Pin 21 (brown 1,5mm²)

Attach standard lines for power supply and ground to 2 – pole plug housing (black) supplied.

Pin 1 (red/ white 1,5mm²)
Pin 2 (brown 1,5mm²)

Attach wires for power supply and ground of Brabus wiring – harness to standard suspension control unit - plug.

Pin 47 (red/ yellow 1,5mm²)
Pin 21 (brown 1,5mm²)

Connect Brabus wiring harness to 2 – pole connector (color equal).

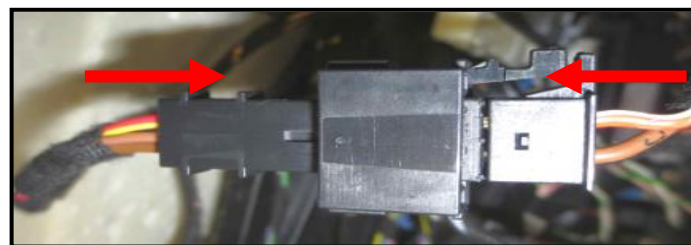
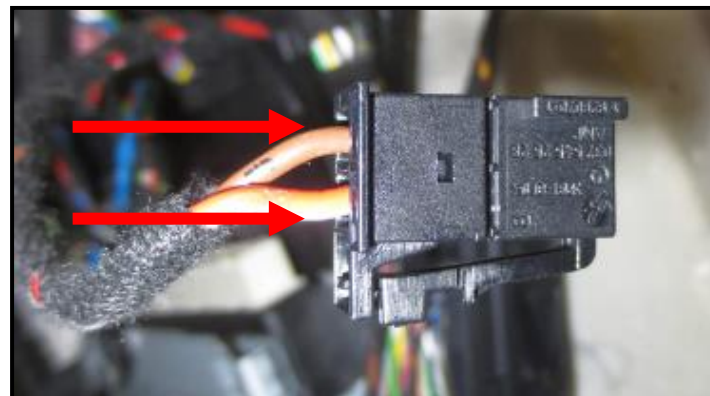



Remove one of the green CAN - plugs out of the white CAN – distributor (with colors blue/ blue – white) on the passenger side.
Remove the lines out of the green plug using a suitable unlocking tool and attach these to the small 2 – pole plug housing supplied.

Connect the plug to the 2 – pole socket of the Brabus wiring harness.
Attach the CAN lines of the Brabus wiring harness to the 2 – pole green standard plug (take care for correct polarity) and attach the plug back to the CAN – distributor.

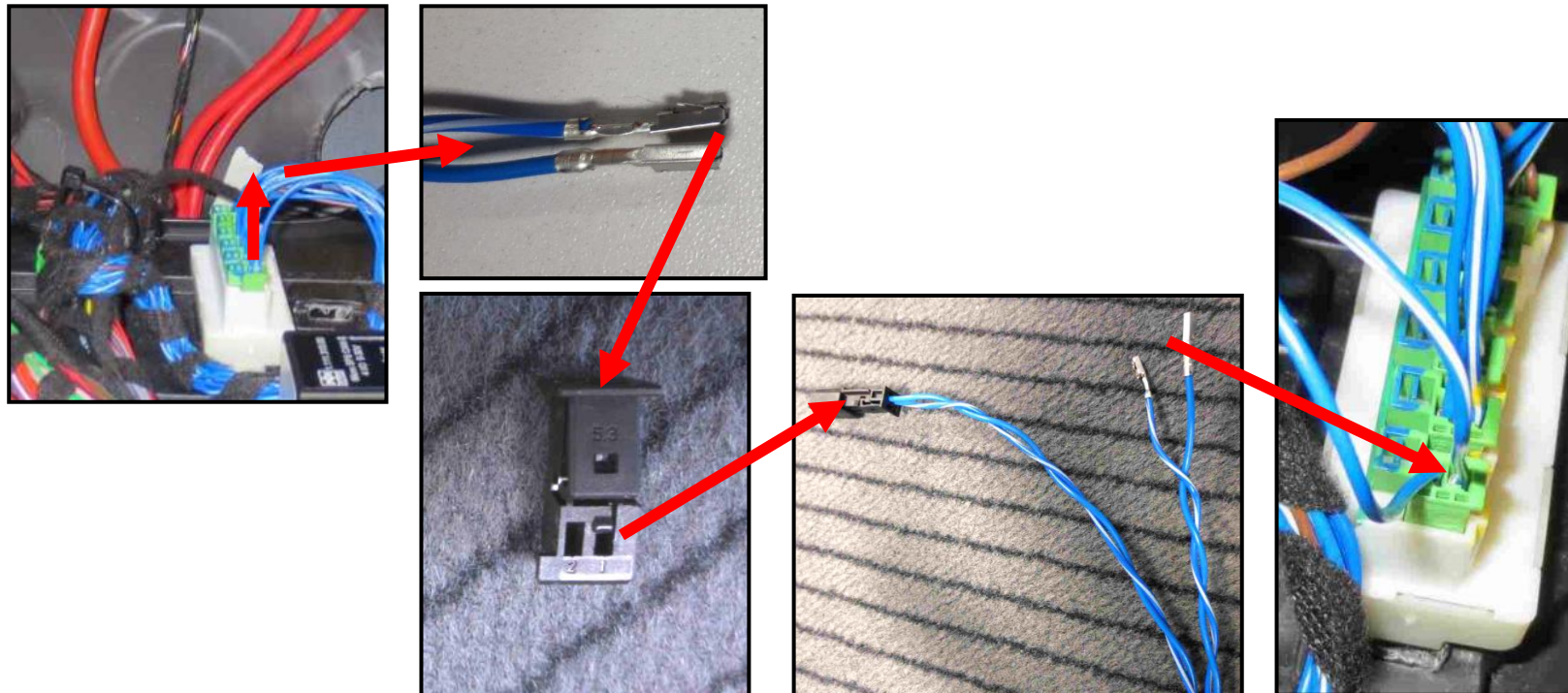



Attach the lowering module to the area next to the standard control unit shown using velcro – tape supplied.



Attention: The lowering module is secured by fuse F320 (15Amps, Magic body control) within fuse panel “dashboard” (F1/6, right footwell).

Re – attach all trim parts, re – connect the ground line to the car main battery.

Start the engine, close all doors and adjust the suspension to the highest level, the again lower the car to the standard position.

